



## September 13<sup>th</sup> Pizza Train Club Outing To Tipton

### September 13<sup>th</sup> ILSR Club Event

*(hopefully everybody planning to go has sent in your reservations and check to Marion Hensley. Picture below is a flash-back from last year.)*



### ALL A BOARD!

As of this Newsletter, we still have two more Club events after our Pizza Train excursion.

**NEW CLUB EVENT ON OUR CALENDAR  
DAYTON, OHIO TRAIN SHOW**

**H**ard to believe we are approaching the Fall season of the year. Yes - we have all enjoyed a busy Summer season - taken family vacations, celebrated the 4th of July, as well as attended several great Train Club activities. But, where has all the Summer gone and why has it gone by so FAST?

Anyway, I want to remind everyone who made your Pizza Train reservations for our Pizza Train excursion on Sat., September 13, to be sure to be at Hobbs Station in Noblesville at **4:30 P.M.** to pick up your tickets and get settled into your seats. Remember, the "Blue Arrow Pizza Train" departs Noblesville for Tipton promptly at **5:00**. It's not every Train Club that gets to take an annual train trip every year! Let's enjoy the evening together.

## In This Issue

Pizza Train Club outing . . . . .	Page 1
Annual Train Show / Trains, Planes - -	Page 2
Poker Run/25th Club Anniversary . .	Page 3
Indiana State Fair Train . . . . .	Page 4
Rence Warehouse Workshop Project	Page 5
Rence Warehouse Workshop Project	Page 6
Rence Warehouse Workshop Project	Page 7
2014 Club Event Calendar . . . . .	Page 8

# TRAINS, PLANES AND AUTOS

- James Driesbach

## 2014 40TH ANNUAL DAYTON TRAIN SHOW

Sat., Nov. 1 - 11:00 A.M. to 5:00 P.M.

Sun., Nov. 2 - 11:00 A.M. to 4:00 P.M.

For those of us who love to attend large Train Shows, this is a "BIG ONE"! I am including this info for everyone to put on your calendars now, because the next Newsletter (NOV- ISSUE) will be too late for folks to make plans. **Our Club's Modular Division** has been invited to exhibit our Club's Modular G-Scale Railroad Sat. & Sun.

These shows have over 400 tables of model railroad needs and wants for all levels in the hobby. There will be new and pre-owned locomotives, rolling stock and structures from "G", "O", "S", "HO", "N", and some "Z" gauges.

For more information and directions to the **Hara Arena**, please visit the "Dayton Train Show 2014" Web Site.

\* \* \* \* \*

## CHRISTMAS PARTY OPEN HOUSE

Sat., Dec. 6

Home of Jacquie and Randy Banks

I know most of us already have this "Last Club Event of the Year" already on your calendars. Details of this Club event will, of course, appear in the Nov. Newsletter.

I just wanted to point out that as of this newsletter, everyone has 3 Club events left to attend before year's end. With all of these activities, there is no reason not to attend at least one of these events. Collecting and running large scale trains is a **FUN HOBBY**, but it's even more fun when you can share the fun with others. You might even learn something while you're having fun.

July 12th ILSR Club activities all centered around the the Modular Show at the Castleton Christian Church on Hague Road. We had a good show and crowd considering it was a neighborhood church function.

We filled the church gym with a 40'X50' modular layout for the 2 day show. People attending this event were treated to some impressive train operation. On Saturday, Andy and I put together three dash 9's with **ten USA Trains new auto carrier cars**. Quite impressive indeed!

On Sunday, we put together a consist of three dash 9's pulling 41 freight cars. It looked great snaking its way through 3 corners plus the trestle with engines and cars still passing on both ends.

Two videos of these operations are showing on our Club website. Most of you have probably already seen them by this time, but in case you haven't yet, be sure to do so. They are worth seeing more than just once! - photos below by Jacquie Banks



Our **Modular Division club members** really have developed an impressive, crowd pleasing, G Scale layout. (note the curved trestle bridge on right)



**RON LOUDERMILK**  
(CREWMAN)



**CIRCUS DISPLAY**



**O**ur ILSR Club's **Poker Run** and **25th Anniversary Family Picnic** on August 16 was a lot of fun and something totally new. Neither rain, nor fog, nor chill of day would stop these railroaders from their play!

Approximately 30 hardy members gathered in the Fortune Academy parking lot (*adjacent to the 1908 Interurban Station at Ft. Harrison*). It was cool and foggy, with an obvious threat of rain and, in fact, it was sprinkling when the first car left on it's destination.



This was the first stop of the inaugural Poker Rally in which each team (car) received their first playing card. Moving along Pendleton Pike, there were three other stops, manned by **Darrell & Lucinda Jackson, Marion & Marthanna Hensley** and **Jeff Carter**. At each stop, teams received another playing card. These stops included a caboose and a fantasy barbershop (*which several lucky members got to tour*).



After a yummy pitch-in meal, prizes were awarded for the best "poker hands". The BIG winner was **Brandon Carney**, who won a collectable 1989 LGB Convention car.

There were multiple consolation prizes . . . it is obvious that Poker is NOT our forte!

Despite the inclement weather, a fun time was had by all! *- Article and photos by Jacquie Banks*



# FAMILY PHOTO ALBUM OF 2014

## INDIANA STATE FAIR TRAIN

- Bud Hunter



AN "INDIANA TRADITION"



Sometimes, we as Large Scale Railroaders, have no choice but to build a new building for the layout that is appropriate and is just not commercially available. Such was the case for my 13 year old grandson Rence, who lives with his parents in Adrian , Michigan.

Six years ago, Rence and I built his G Scale railroad. Of course, we had to include **one siding** so he would have a purpose in operating as well as switching his new train. Granddad built him a “temporary” warehouse building. Built out of wood, without a lot of fancy detail, this worked fine in his basement for a few years. When Rence was 10 years old, we moved his railroad outside and, unfortunately, his wooden warehouse warped and deteriorated badly.

There was no choice, but to build a better warehouse that would look somewhat modern, but more importantly would hold up well for outdoors use. Last winter, I got busy in my basement workshop to build a Warehouse.

First decision was to draw a plan for the size of the building. The second decision was not to use any wood. Instead, it would be built from ¼ inch plexiglas sheets (easily available from the local Lumber Center). A side benefit to this is that the Lumber Center would cut the plexiglas panels to the dimensions that I specified in my drawings. All I had to do was cutout the windows and doors. My good friend, Rex Bowman, donated some

spare window and door parts from an Aristo building he had picked up at a garage sale a few years ago.

So, the **first item of business** was to draw a building plan.

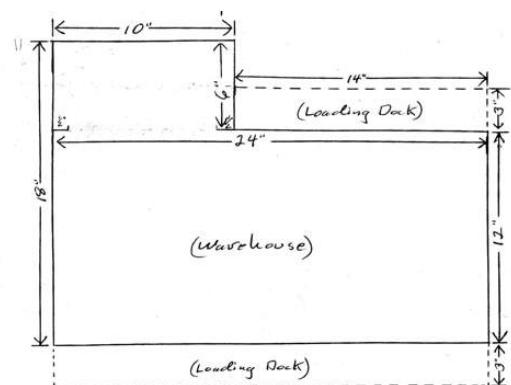

The above plan is what I drew. After I had the panel parts, I epoxied the walls together and used silicone calk to reinforce all wall joints. After I was satisfied that the walls were all square and rigid, I measured and cut out the 3 windows and 1 office door opening.

In a nutshell, this meant measuring and drawing the window size on the plexiglas panels with a black marker pen. Then, using an electric drill, I drilled close to 50 holes per window along the outline of the window frame.

With the window/door patters drilled out, my Dremel tool had an easy time of cutting out between the holes and burnishing off any rough spots.



I found this project became more interesting and fun as the Warehouse progressed. Now I needed to laminate **brick siding** onto the sides of the walls to give the appearance of a building. I went to **Hobbytown USA** in the Castleton Mall area to find G scale plastic siding. They did not have concrete block siding that I wanted, however they did have sheets of G Scale brick siding, so this is what I selected.

This product comes 2 sheets to a pak, so I purchased 3 paks. I trimmed the sheets to fit and glued them to the plexiglas sides of the building using DAP Contact Cement.

**Note: Be sure to view this ILSR Newsletter on our Club's website if you would like to see these warehouse photos in full color.** - Bud

After the walls were glued, I filled any wall joint cracks with Red Devil lightweight spackling. This product will not shrink or crack and is good for interior/exterior use - and is water clean up & ready to use.

Next comes the painting. I used a Rust-Oleum, Multicolor Textured spray paint that laid down a wonderful, weathered brick look. The color selection was **Desert Bisque**. (Available at Lowes, Menards, and other home improvement stores.) Windows and door was sprayed a chocolate brown. Six overhead doors were cut out of corrugated plastic sheets also from Hobbytown USA. These six doors were sprayed silver.



I am becoming more amazed with this project as progress is made. The building has the weight and heft of a comparable Piko or Pola building. I only hope that it will hold up to the outdoors environment as well. Now, lets finish up with the roof.



The flat roof details went easily. Basically, I had the Lumber Center cut me 7 rectangles of clear plexiglas. I also bought some “hardware cloth” screen wire. Epoxied on the roof, these became 7 sky-lights to help light the interior of the building. Using masking tape, I calked a bead of calk around each sky light and leveled off with a scraper tool. Finally, I brush painted the roof with an outdoor slate gray color. (3 coats)  
The **Rence Warehouse** sign was engraved at a trophy shop outside of Lebanon. The silver vents are wooden axle parts available at Hobby Lobby. The black pipes in the roof are made of assorted plastic pipes.

This past May, we installed this warehouse on Rence’s Garden Railroad. Needless to say, Rence was excited. Now at the end of August, I can say that the Warehouse is holding up well to being outside all the time. The only problem encountered so far is the brick sheeting has pulled away slightly in 2 spots on the west side, which gets the brunt of afternoon sun. This I will repair this on our next visit to Michigan. Rence might want to consider taking the building inside the garage when his railroad is not being used. Over all, Rence’s CSX Garden Railroad is looking good and brings a lot of pleasure to all that see it.



An eastbound CSX (*photo above*) is busy switching out a box car of merchandise at the “**Rence Warehouse**”. A semi-trailer is parked in the “parking lot” on the north side of the warehouse. In other words, big shipments come in by train and are distributed by truck.

## ILSR Club Officers

### President - Jacquie Banks

7621 Fall Creek Rd.; Indianapolis  
[jacrabit@att.net](mailto:jacrabit@att.net) 46256  
 (317) 849-9501

### V.P. (Programs) - James Driesbach

453 West Osage St.; Greenfield, IN.  
[jddriesbach@aol.com](mailto:jddriesbach@aol.com) 46140  
 (317) 529-2561

### Newsletter Editor - Bud Hunter

1214 Morningside Dr.; Lebanon, IN  
[nhunter@mymetronet.net](mailto:nhunter@mymetronet.net) 46052  
 (765) 482-6608

### Treasurer/Sec. - Marion Hensley

11675 Atlantic Rd.; Fortville, IN.  
[mchmjh@embarqmail.com](mailto:mchmjh@embarqmail.com) 46040  
 (317) 485-4140

### Membership - Jeff Carter

(317) 253-9310  
[jcchome@sbcglobal.net](mailto:jcchome@sbcglobal.net)

### Website - David Palmeter

(317) 770-4919

## 2014 Club Event Calendar

Nov. 1 & 2    Modular NMRA Train Show in Dayton,  
Ohio    *(Please check our Club's website for  
location & times)*

Dec. 6        Christmas Party Open House  
and Annual Meeting  
Home of Randy & Jacquie Banks  
(More details covered in the Nov. Newsletter)



Overview of Rence's CSX Garden Railroad. This railroad is built with approximately 100 feet of Aristo Stainless Steel track.



